

# General turning Boring bars

DC\*\* steel boring bar **S-Clamping**

SDQCR/L Kr: 107°30'

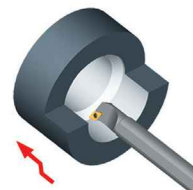
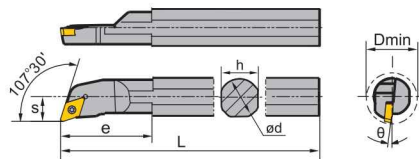
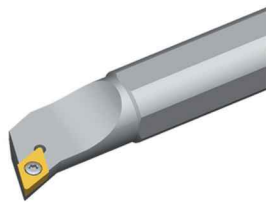

Right hand style

Article	*	Stock		Dimensions [mm]								Inserts
		R	L	ød	L	h	s	L <sub>2</sub>	e	D <sub>min</sub>	θ	
S10M-SDQCR/L07	●	●	10	150	9	7	20	20	13	-8	DC**0702**	
S12M-SDQCR/L07	●	●	12	150	11	9	22	22	16	-8	DC**0702**	
S16M-SDQCR/L07	○	●	16	150	15	11	27	27	20	-6	DC**0702**	
S16Q-SDQCR/L07	●	●	16	180	15	11	27	27	20	-6	DC**0702**	
S16R-SDQCR/L07	●	●	16	200	15	11	27	27	20	-6	DC**0702**	
A10H-SDQCR/L07	*	●	10	100	9.5	7	20	20	13	-8	DC**0702**	
A12K-SDQCR/L07	*	●	12	125	11.5	9	22	22	16	-8	DC**0702**	
S20Q-SDQCR/L11	●	○	20	180	18	13	32	32	25	-6	DC**11T3**	
S20S-SDQCR/L11	●	●	20	250	18	13	32	32	25	-6	DC**11T3**	
S25Q-SDQCR/L11	●	○	25	180	23	17	32	32	32	-6	DC**11T3**	
S25T-SDQCR/L11	●	●	25	300	23	17	32	32	32	-6	DC**11T3**	
A16M-SDQCR/L11	*	●	16	150	15.5	11	27	27	20	-6	DC**11T3**	
A20Q-SDQCR/L11	*	●	20	180	19	13	32	32	25	-6	DC**11T3**	
A25R-SDQCR/L11	*	●	25	200	24	17	32	32	32	-6	DC**11T3**	

● Ex stock ○ On demand

\* With internal cooling

### Spare parts

Insert	DC**0702**	DC**0702**	DC**11T3**	DC**11T3**	DC**11T3**
	10	12-16	16-20	20	25
Screw	I60M2.5×5.5 (1.0 Nm)	I60M2.5×6.5 (1.0 Nm)	I60M3.5×8 (2.7 Nm)	I60M3.5×8 (2.7 Nm)	I60M3.5×10 (2.7 Nm)
Wrench (screw)	WT07IP	WT07IP	WT15IP	WT15IP	WT15IP

### Insert

<b>Finishing</b> A126	<b>Medium Cut</b> A127	<b>Roughing</b> A129	<b>Alum Machining</b> A129	<b>Cast Iron</b> A129	<b>PCBN/PCD</b> A184

System code > A322

Grade selection > A42

Technical info > A501

Cutting data > A366