

Face milling

FMR02

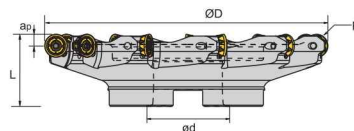
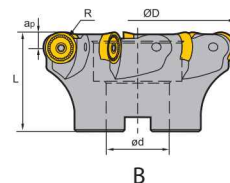
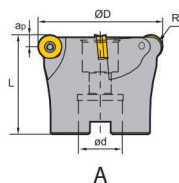
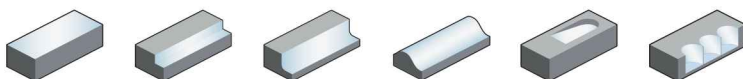

C

Article	*	Stock	Dimensions [mm]					Teeth	Coupling	kg	Inserts
			R	ØD	ød	L	a _{p max}				
FMR02-050-A22-RC12-05C	*	●	6	50	22	40	6	5	A	0.7	RCGX1204 RCKT1204 RCMW1204
FMR02-050-A22-RC12-06C	*	○	6	50	22	40	6	6	A	0.7	
FMR02-052-A22-RC12-05C	*	●	6	52	22	40	6	5	A	0.7	
FMR02-063-A22-RC12-04		●	6	63	22	40	6	4	A	0.7	
FMR02-063-A22-RC12-05C	*	●	6	63	22	40	6	5	A	0.7	
FMR02-063-A22-RC12-06		●	6	63	22	40	6	6	A	0.7	
FMR02-063-A22-RC12-06C	*	●	6	63	22	40	6	6	A	0.7	
FMR02-080-A27-RC12-07C	*	●	6	80	27	50	6	7	B	0.7	
FMR02-100-B32-RC12-08C	*	●	6	100	32	50	6	8	B	0.89	
FMR02-063-A22-RC16-04		●	8	63	22	40	8	4	A	0.7	
FMR02-063-A22-RC16-04C	*	○	8	63	22	40	8	4	A	0.7	
FMR02-063-A22-RC16-05C	*	○	8	63	22	40	8	5	A	0.7	
FMR02-066-A27-RC16-05C(FB)	*	●	8	66	27	50	8	5	A	0.5	
FMR02-080-B27-RC16-05		●	8	80	27	50	8	5	B	0.7	
FMR02-080-B27-RC16-07		●	8	80	27	50	8	7	B	0.7	
FMR02-100-B32-RC16-06		●	8	100	32	63	8	6	B	1.2	
FMR02-100-A32-RC16-06C	*	○	8	100	32	63	8	6	B	1.2	
FMR02-125-B40-RC16-07		●	8	125	40	63	8	7	B	2.5	
FMR02-125-B40-RC16-07C	*	○	8	125	40	63	8	7	B	2.5	
FMR02-160-B40-RC16-10(FB)		○	8	160	40	63	8	10	B	3.94	
FMR02-200-C60-RC16-12(FB)		●	8	200	60	63	8	12	C	5.4	
FMR02-080-A27-RC20-04		●	10	80	27	50	10	4	A	0.7	RCKT2006
FMR02-080-A27-RC20-04C(FB)	*	●	10	80	27	50	10	4	A	0.7	
FMR02-100-B32-RC20-05		●	10	100	32	63	10	5	B	1.2	
FMR02-100-B32-RC20-06		●	10	100	32	63	10	6	B	1.2	
FMR02-100-B32-RC20-06C	*	○	10	100	32	63	10	6	B	1.2	
FMR02-125-B32-RC20-05		○	10	125	32	63	10	5	B	1.2	
FMR02-125-B40-RC20-06		●	10	125	40	63	10	6	B	1.2	

● Ex stock ○ On demand

* With internal cooling



System code > B26

Grade selection > B24

Technical info > B527





Cutting data > B230

Indexable milling

Article	*	Stock	Dimensions [mm]					Teeth	Coupling		Inserts 
			R	ØD	ød	L	a _p max				
FMR02-125-B40-RC20-07		●	10	125	40	63	10	7	B	2.2	RCKT2006
FMR02-125-B40-RC20-07C	*	○	10	125	40	63	10	7	B	2.2	
FMR02-160-B40-RC20-08		●	10	160	40	63	10	8	B	4.2	
FMR02-160-B40-RC20-08C	*	○	10	160	40	63	10	8	B	4.2	
FMR02-250-C60-RC20-10		●	10	250	60	63	10	10	C	8.49	
FMR02-250-C60-RC20-11		○	10	250	60	63	10	11	C	8.37	

● Ex stock ○ On demand

* With internal cooling

Spare parts					
	Insert	RCGX1204 RCKT1204 RCMW1204	RCKT1606	RCKT2006	
	ØD	50-100	63-200	80-250	
	Screw (insert)	I60M3.5×10 (2.7 Nm)	I60M5×13 (6.7 Nm)	I43M6×16 (9.1 Nm)	
	Wrench (insert)	WT15IS			
	Wrench (insert)		WT20IT	WT25IT	

A

Turning

B

Milling

C

Drilling

D

Technical
Information

E

Index

System code > B26

Grade selection > B24

Technical info > B527

Cutting data > B230

A

Turning

B

Milling

C

Drilling

D

Technical Information

E

Index

RCKT	I.C	S	d
12 04	12	4.76	4
16 06	16	6.35	5.56
20 06	20	6.35	6.55

- Ideal machining conditions
- Normal machining conditions
- Unfavourable machining conditions

Milling inserts

RC** milling insert		HC ¹ (CVD)						HC ¹ (PVD)					HT	HC ²	HW										
		P	M	K	N	S	H																		
		ISO	YBC302	YBC301	YBC401	YBM253	YBM251	YBM351	YBD152	YBD252	YBG101	YBG102	YBG202	YBG212	YBS203	YBG205	YB9320	YBG302	YBS303	YBG252	YNG151	YNG151C	YD101	YD201	
		RCKT1204MO-DM	○	○		○	●	○					○				●	○							
		RCKT1606MO-DM	○													●	●								
		RCKT2006MO-DM	○																						
		RCKT1204MO-DR	○	○		○	●									●									
		RCKT1606MO-DR	●	○	●		●	●									●								
		RCKT2006MO-DR	●	○	●		○	●				○						○							
		RCKT1204MO-ER				●																			
		RCKT1606MO-ER				●																			
		RCKT2006MO-ER				●																			
		RCKT1204MO-NM										○													
		RCKT1606MO-NM										○													

● Ex stock ○ On demand

HC¹ Coated carbide
 HT Uncoated cermet
 HC² Coated cermet
 HW Uncoated carbide

System code > B26

Grade selection > B24

Technical info > B527

Cutting data > B230

